



FULL PORT THREE-PIECE BALL VALVE FLANGE END DIN-PN16/40

TC171 CARBON STEEL WCB/DIN1.0619
 TC172 STAINLESS STEEL 304/DIN1.4308
 TC173 STAINLESS STEEL 316/DIN1.4408

FEATURES:

- FACE TO FACE DIMENSION: DIN 3202-F1
- END FLANGE DIMENSION: PN16 / PN40 DIN 2633
- BLOW-OUT PROOF STEM / FULL PORT
- INVESTMENT CASTING BODY
- DESIGN: ANSI B16.34
- TEST: EN 12266-1
- 1/2"-2"PN40,2 1/2"-4"PN16
- LEVER OPERATED / LOCKING DEVICE
- MATERIAL: CARBON STEEL WCB/DIN1.0619
 STAINLESS STEEL 304/DIN1.4308
 STAINLESS STEEL 316/DIN1.4408

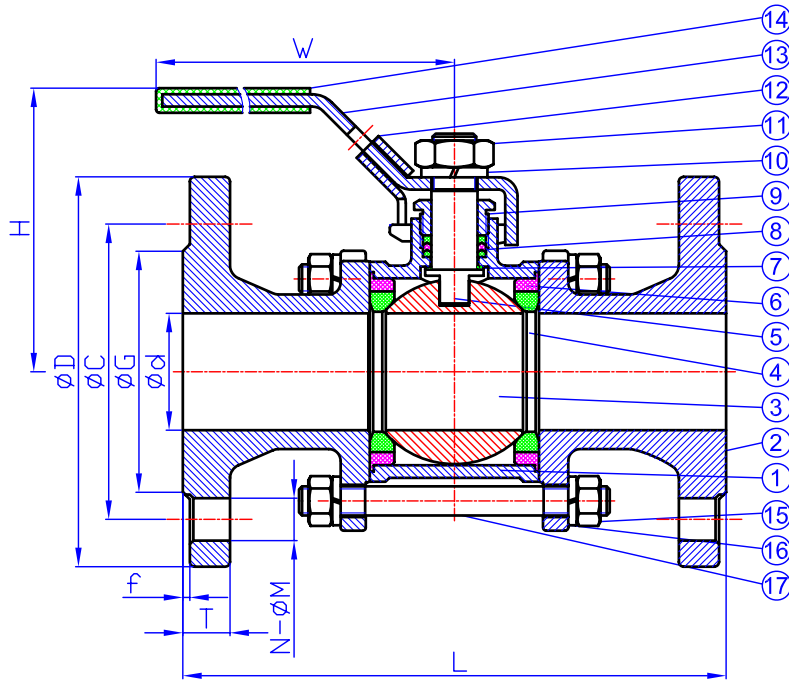

MATERIALS LIST:

NO.	PART NAME	MATERIAL		
		1.0619	1.4308	1.4408
1	BODY	1.0619	1.4308	1.4408
2	CAP	1.0619	1.4308	1.4408
3	BALL	1.4308	1.4308	1.4408
4	SEAT	PTFE		
5	STEM	SUS316		
6	GASKET	PTFE		
7	THRUST WASHER	PTFE		
8	PACKING	PTFE		
9	GLAND	SUS304		
10	SPRING WASHER	SUS304		
11	STEM NUT	SUS304		
12	LOCKING DEVICE	SUS304		
13	HANDLE	SUS304		
14	PLASTIC COVER	PLASTIC		
15	HEX NUT	SUS304		
16	BOLT WASHER	SUS304		
17	JOINT BOLT	SUS304		

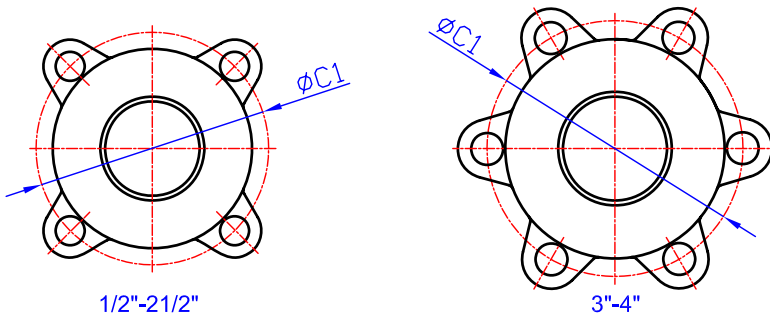

DIMENSIONS:

SIZE	d	D	C	G	f	T	N	M	C1	L	H	W
15	15	95	65	45	2	16	4	14	52.0	130	68	123
20	20	105	75	58	2	18	4	14	55.5	150	80	133
25	25	115	85	68	2	18	4	14	62.5	160	84	133
32	32	140	100	78	2	18	4	18	76.9	180	92	190
40	38	150	110	88	3	18	4	18	86.0	200	98	190
50	50	165	125	102	3	20	4	18	107	230	103	190
65	65	185	145	122	3	18	4	18	134	290	143	264
80	80	200	160	138	3	20	8	18	155	310	154	264
100	100	220	180	158	3	20	8	18	192	350	183	503

TEST PRESSURE:

SHELL(BY WATER)		345PSI
		24kg/cm ²
SEAT	BY WATER	250PSI
		17.5kg/cm ²
	BY AIR	85PSI
		6kg/cm ²